



GOSPADE

UNIVERSAL EBIKE CONVERSION KIT INSTALLATION



 **MID DRIVE**

TABLE OF CONTENTS

Part detail.....	2
Installation steps.....	3
System usage description.....	20
Instructions for the use of a charger.....	26
Things you must know before use.....	27

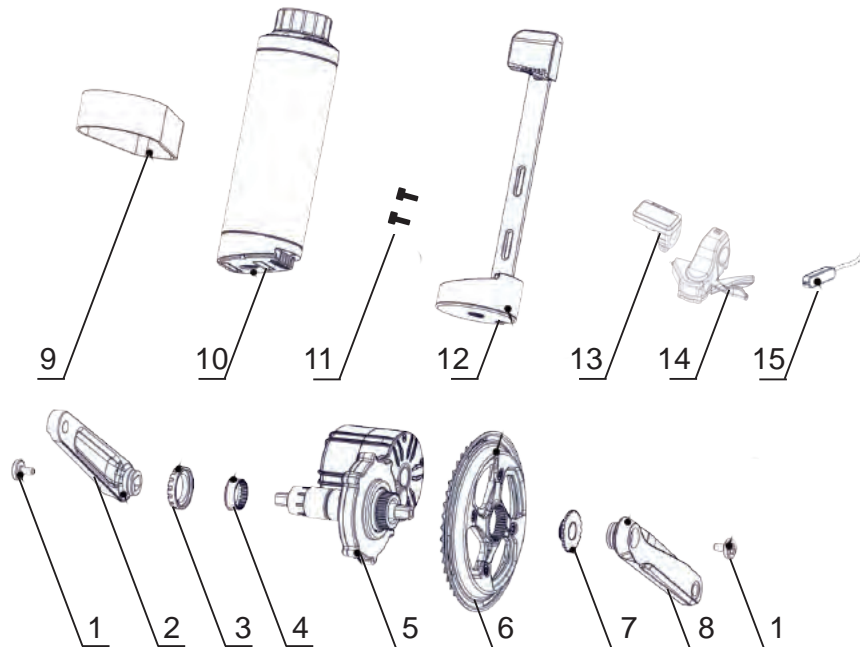

- | | |
|-------------------------------------|--------------------------------|
| 1. L/R crank arm fixing bolt.....x2 | 8. Right crank arm.....x1 |
| 2. Left crank arm.....x1 | 9. Velcro bend.....x1 |
| 3. Bottom bracket cap.....x1 | 10. Battery.....x1 |
| 4. Lock ring.....x1 | 11. Battery holder bolt.....x2 |
| 5. Motor.....x1 | 12. Battery holder.....x1 |
| 6. Chainwheel.....x1 | 13. Display.....x1 |
| 7. Chainwheel lock cap.....x1 | 14. Electronic shifter.....x1 |
| | 15. Speed sensor.....x1 |

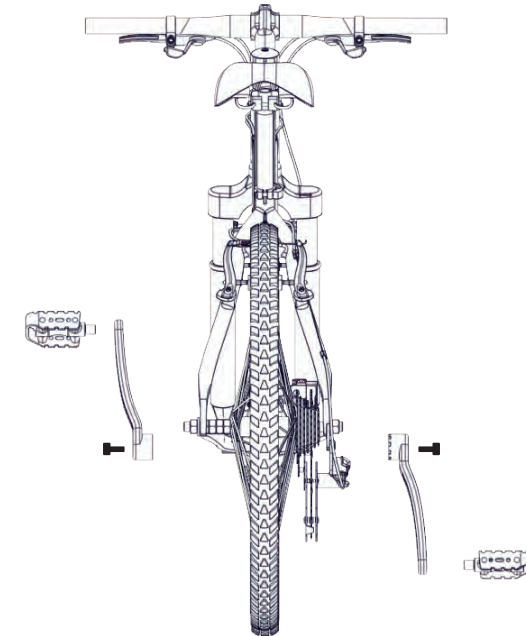

STEP 1:

Remove the L/R pedals and L/R cranks.

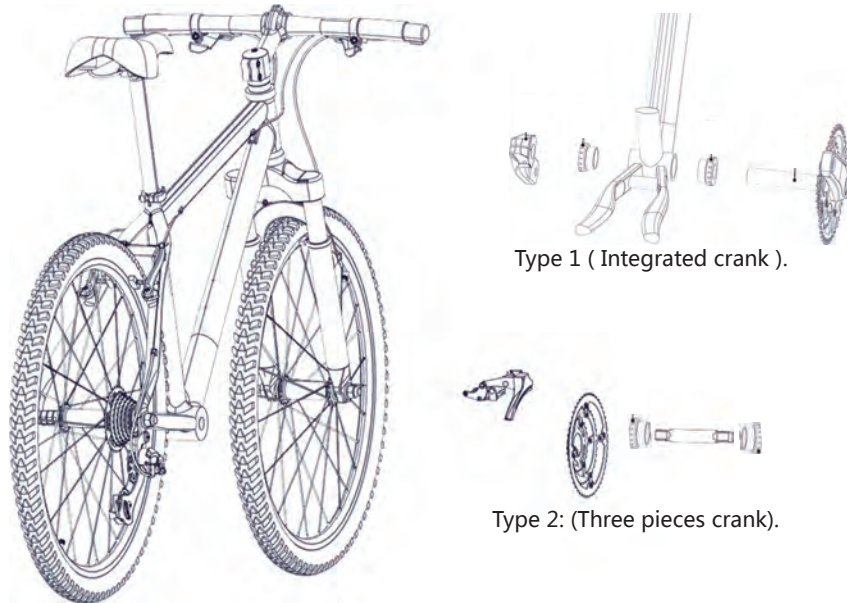

STEP 2 :

Type 1: (Integrated crank)

1. Remove the front derailleur on frame and shifter on handlebar.
2. Loosening the fixing bolt on the L crank arm and remove the arm.
3. Remove the crank set from ride side.
4. Remove the L/R bottom bracket cap on frame.

Type 2: (3-Piece crank)

1. Remove the front derailleur on frame and shifter on handlebar.
2. Remove the chainwheel
3. Loosening the L/R cap on the frame.
4. Remove the axle spindle.

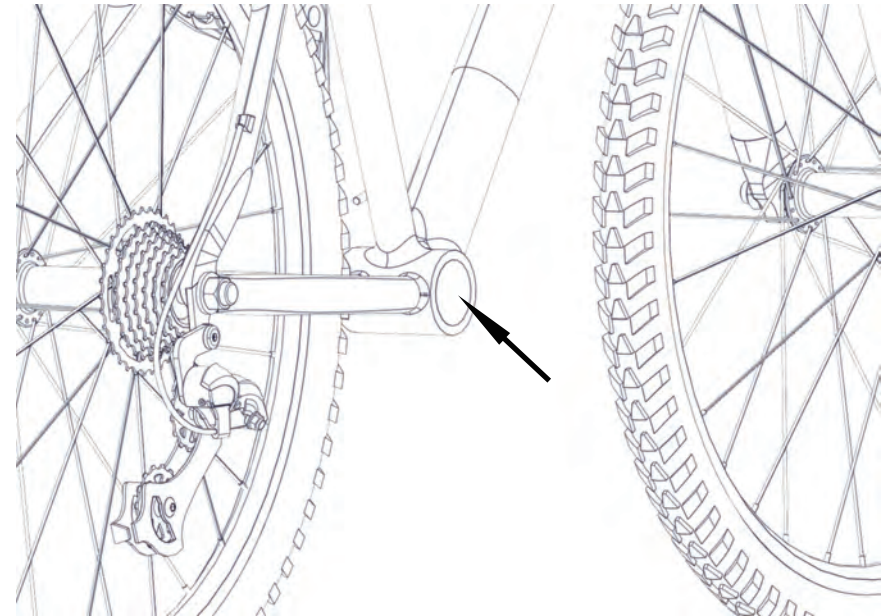

STEP 3 :

Clean up the burrs and oil stains from the bottom bracket first, then use GOSPADE special 33.5mm grinder or reamer to process the correct roundness for the bottom bracket if necessary.

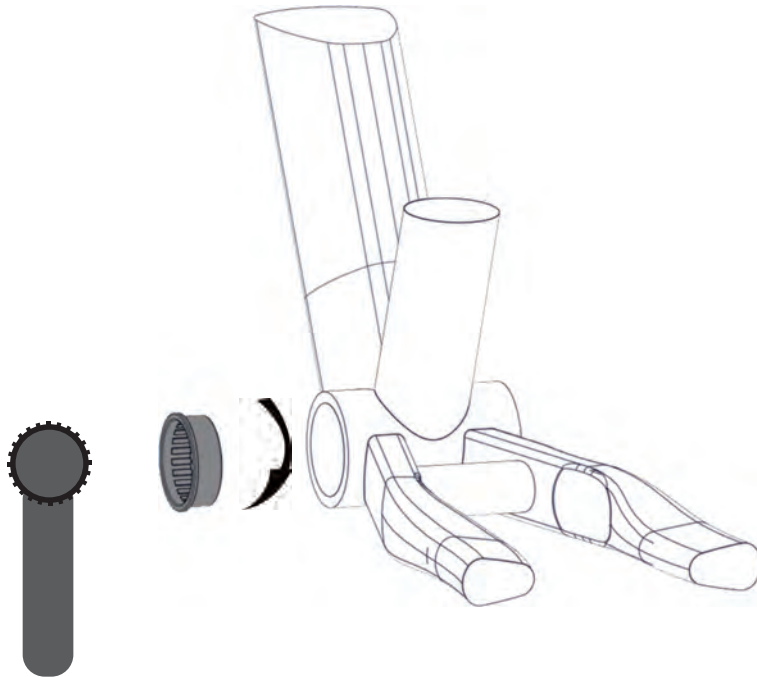

Gospade special tighten tool

STEP 4 :

Use Gospade special tighten tool to install the lock ring into left side of bottom bracket. Turn clockwise to tighten the lock ring. The correct torque should be 40~45N.m.

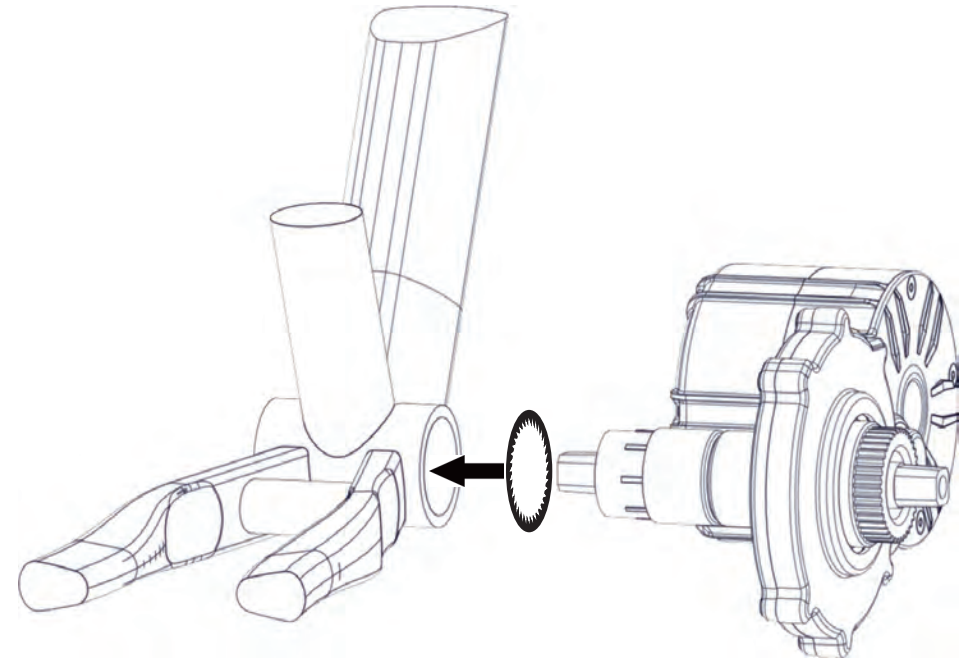

STEP 5 :

Install the motor into the bottom bracket from right side of the frame. The motor angle will be secured by lock ring on the left side of bottom bracket. There are 24 angle positions on the lock ring. Each position is 15 degree angle. Install the motor angle close to the down-tube, but can not be touched to the down-tube.

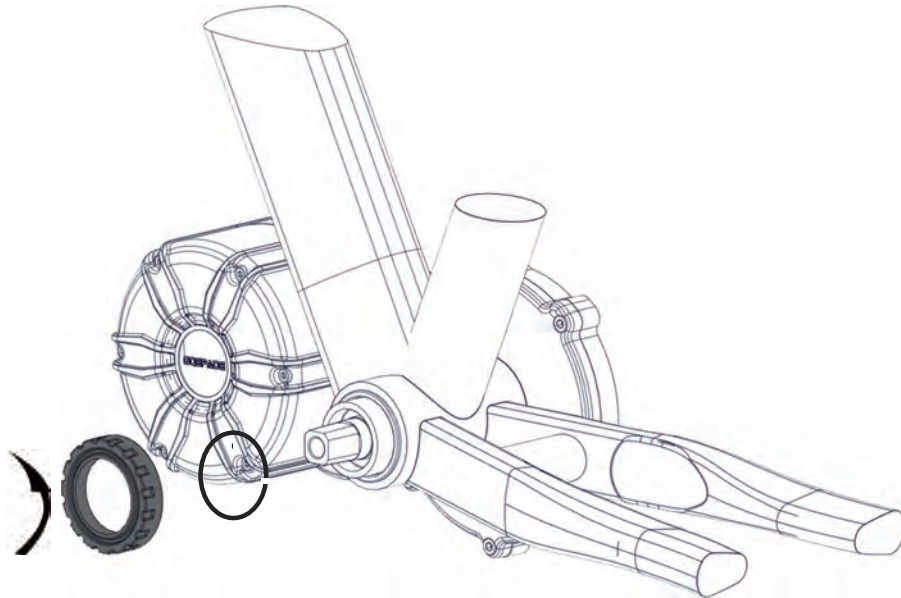

STEP 6 :

Turn counter-clockwise to tighten the cap to secure the motor on the left side of bottom bracket. The correct torque should be 40~45N.m.

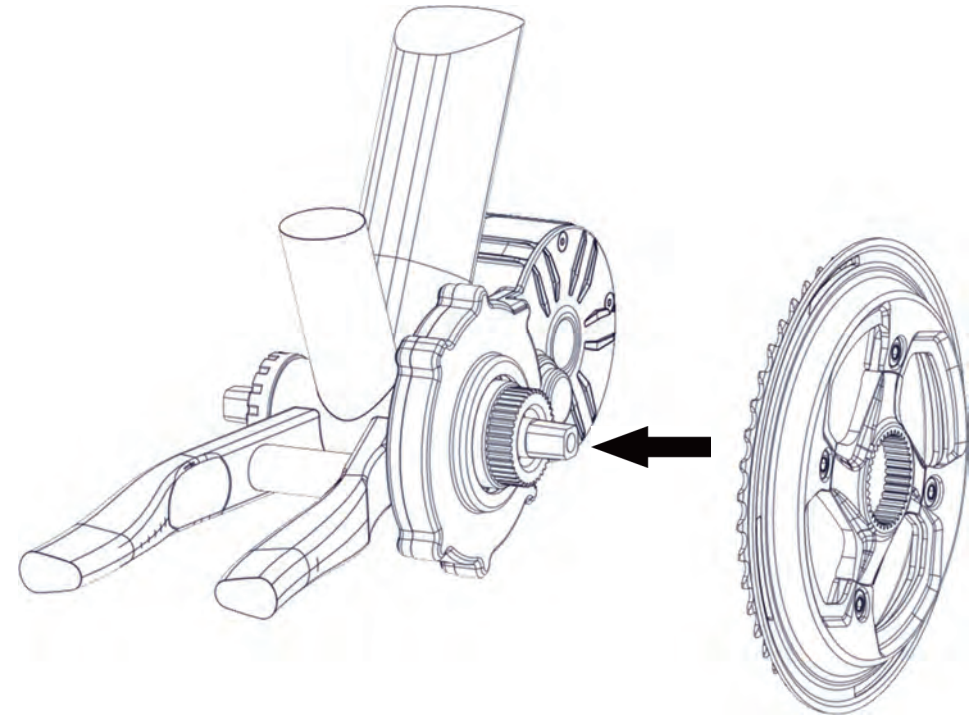

STEP 7 :

Install the chainwheel into the motor square axle.

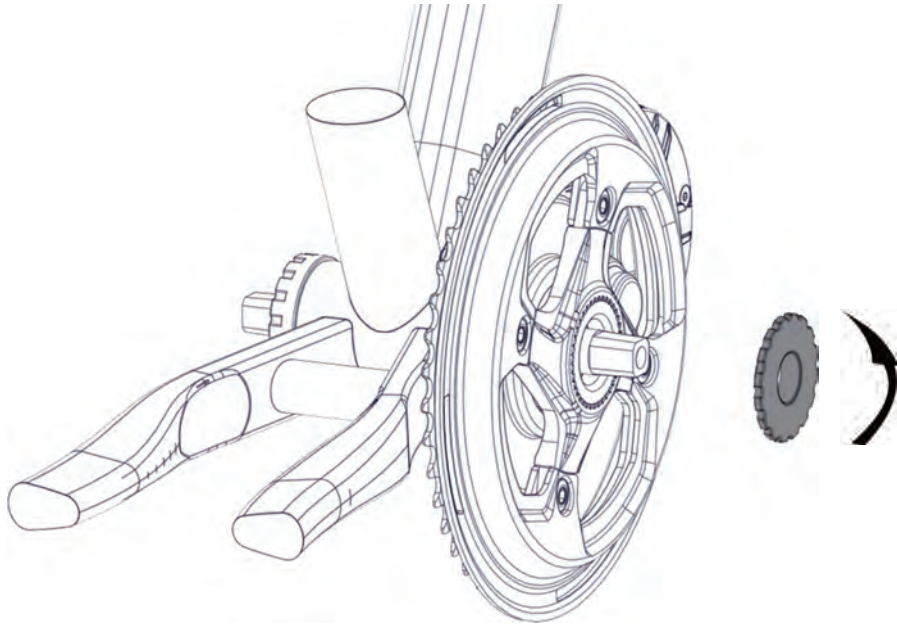

STEP 8 :

Turn counter-clockwise to tighten the lock cap to secure the chainwheel into the axle. The correct torque should be 30~35N.m.

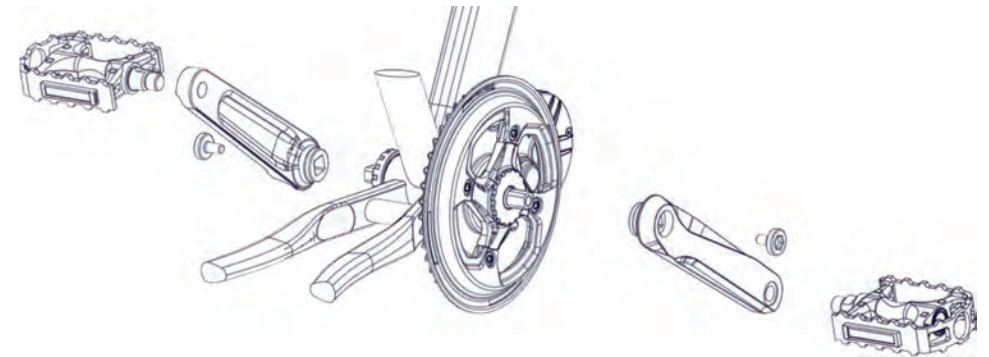

STEP 9 :

1. Install the L/R crank arms into the motor axle. Use the 2pcs M8 bolts to secure the arm. The correct torque should be 35N.m.
2. Install the L/R pedals onto the L/R crank arms. The correct torque should be 25N.m

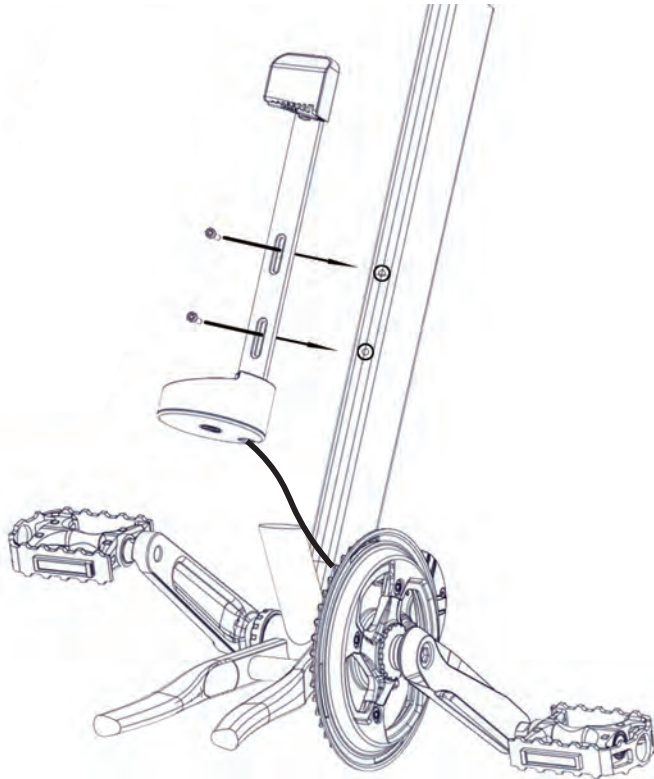

STEP 10 :

Use 2pcs M5 battery holder bolts to secure the battery holder onto water cage holes. The correct torque should be 12N.m

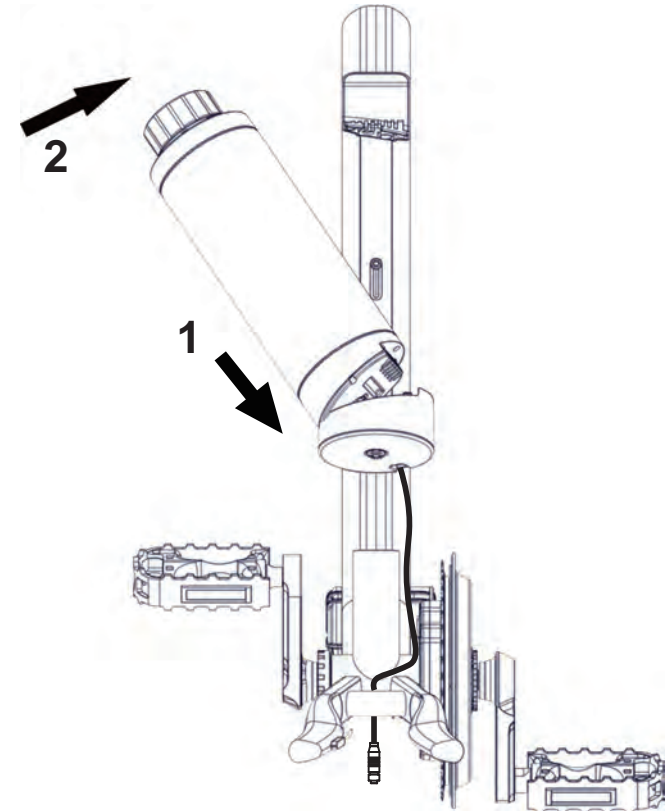

STEP 11 :

1. Place the bottom of battery on battery holder.
2. Move the battery from left to right to secure the battery on the top of battery holder.

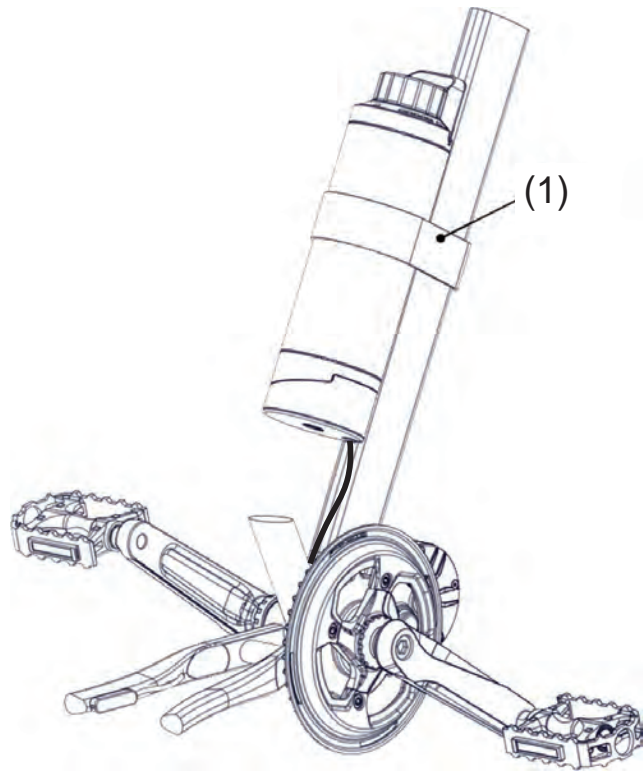

STEP 12 :

We suggest to use the velcro bend to fix the battery on the down-tube to prevent any damages from any circumstances.

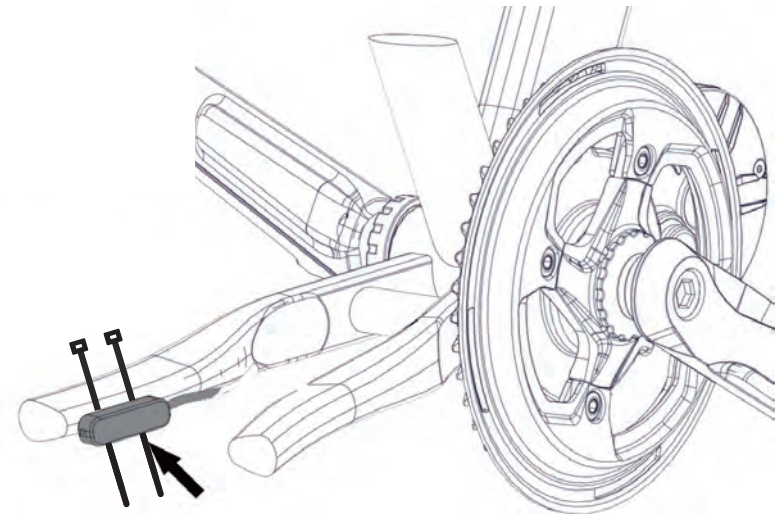

STEP 13 :

Use the 2pcs short zip ties to fix the speed sensor on the inner left chain-stay on the frame. Do not tighten the zip ties yet.

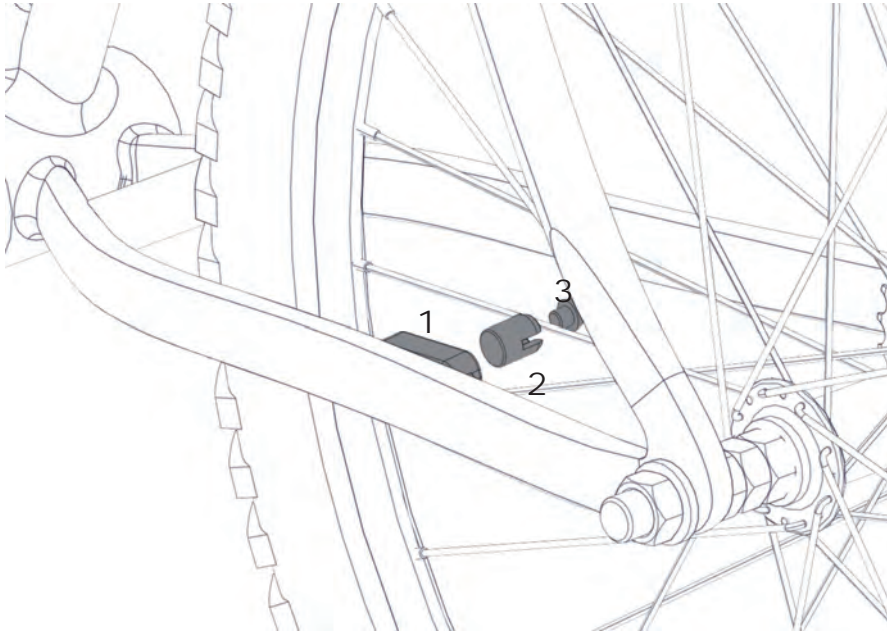

STEP 14 :

1. Install the magnet (2) on the spoke and position it parallel with the end of speed sensor. Tighten the M5 bolt (3) to secure the magnet. The correct torque should be 15N.m.
2. Tighten the 2pcs speed sensor zip ties.

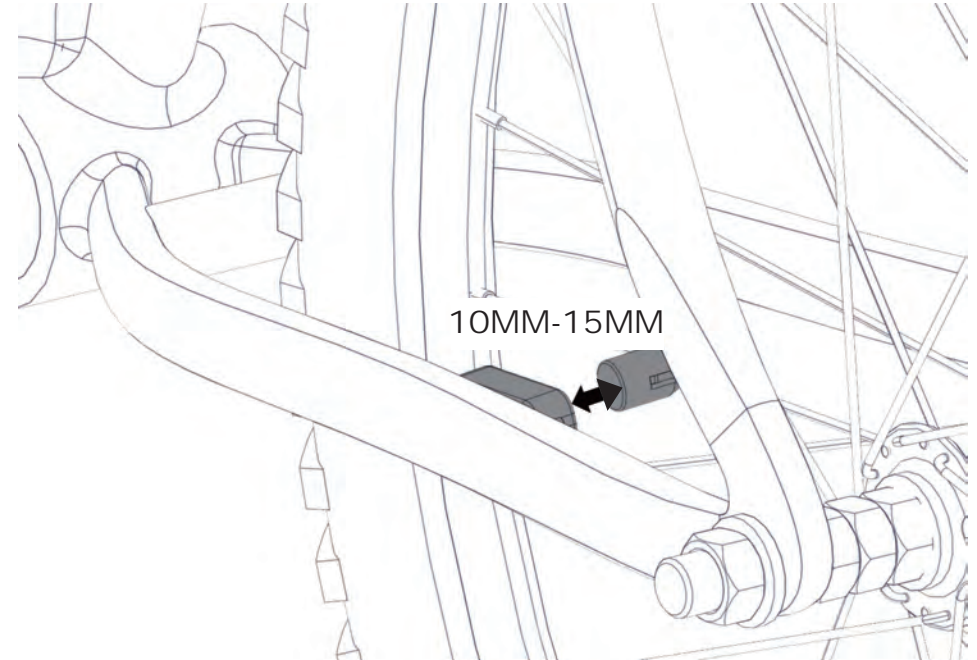

STEP 15 :

The distance between speed sensor and magnet should be 10-15mm.

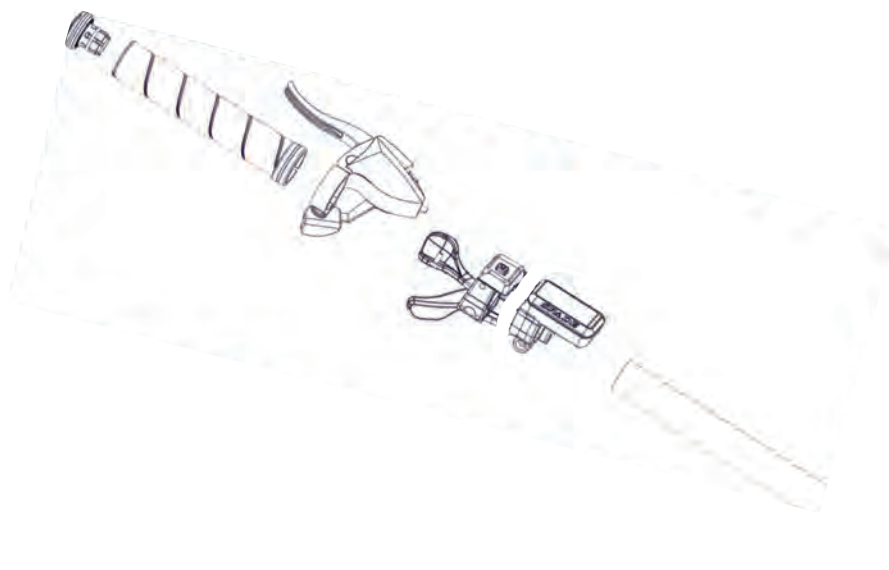

STEP 16 :

1. Install the display and electronic shifter on the left side of handlebar.
2. Install the left grip and left brake on handlebar.



STEP 17 :

1. Connect power cable (Metal connector)
2. Connect speed sensor cable (Orange connector)
3. Connect display & shifter cable (Green connector)
4. Replace the chain back to the chainwheel

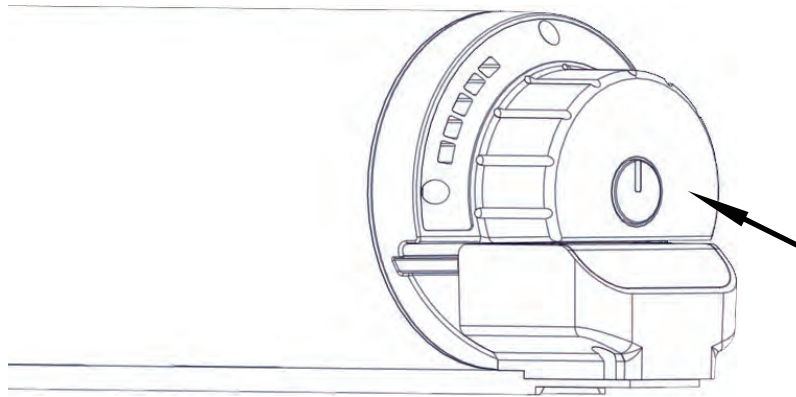

Battery Intruction Manual:

1. Power on: Long press the power switch for 3 seconds.
2. Shut down: Long press power switch for another 3 seconds.
3. Power levels: Press one seconds to switch different power levels.

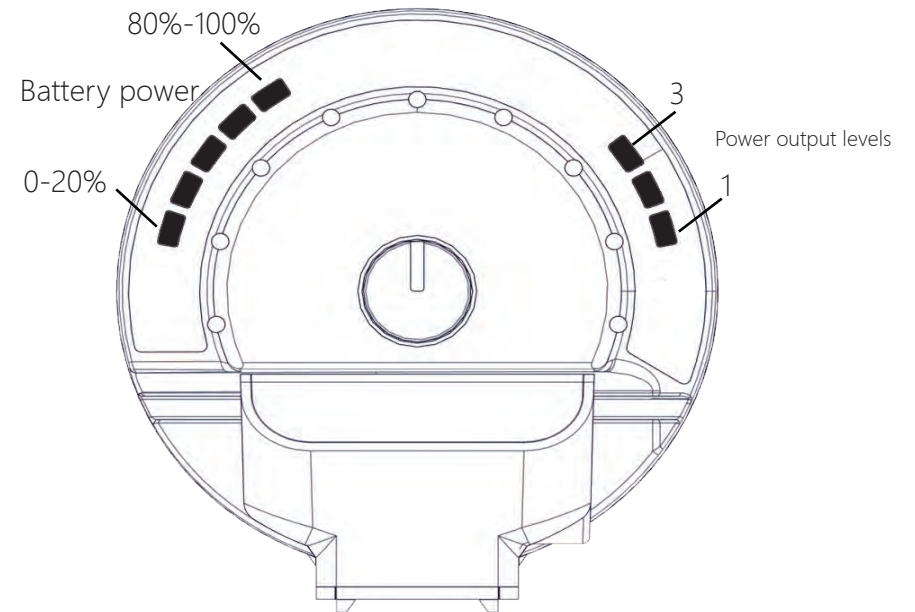

Battery Indicator Light Instruction:

There are 2 different indicator lights on the top of battery for 9 and 10.5Ah battery. The blue lights indicates current battery power capacity status. The green lights indicates current power output level.

Section 1: Speed Calculation



Section 7: Single Trip Distance Calculation



Section 6: Riding Time Calculation



Section 2: Average Speed Calculation

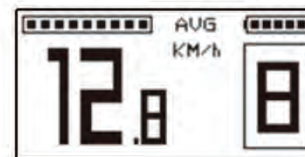

Section 3: Maximum Speed Calculation

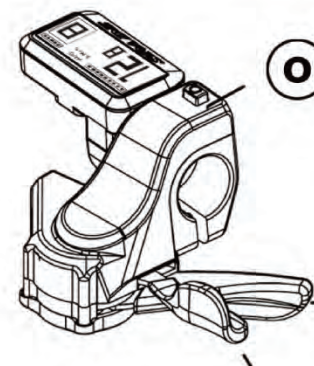

Long press the function button for 3 seconds, the display will be activated.

Toggle the  button to switch the section.

Section 5: Step Frequency Calculation



Section 4: Total Distance Calculation



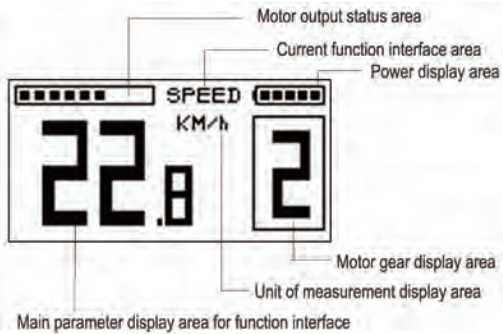

Setup menu control logic settings

Attention: Press "o" and "+" simultaneously to enter the setup menu

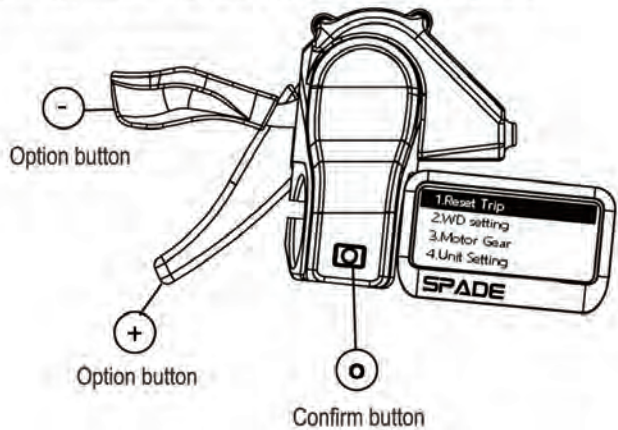

General Setting Menu

Hold both o and + button for 2 seconds the general setting menu Capture of menu setting "Reset Trip" " WD setting" " Motor Gear" " Unit Setting" " Exit"
Press the + and - button to select the content.press the o to comfirm the corresponding setting.

E0 Service	Communication abnormal
E1 Service	Electric current abnormal
E2 Service	Handlebar abnormal
E3 Service	Motor open phase
E4 Service	HALL signal abnormal of motor
E5 Service	Brake abnormal
E6 Service	Low voltage protection

Parallel table of setup menu

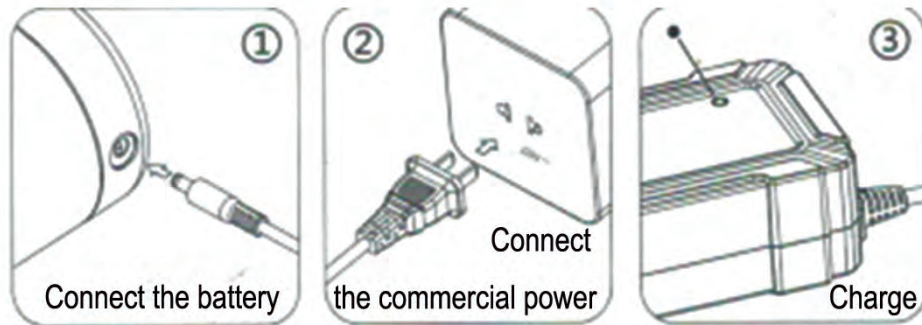

Charging Your Battery

Fully charging your battery before your first ride and then after and after any operation, especially after long distance riding.

1. Shut down the power at the bottom of battery and pull out waterproof rubber plug; charge couple of the charger can be perfectly connected with battery charge interface end to end.
2. Then, battery socket of the charger is inserted into an electrical connector receptacle of 110 AC chamber.
3. After the battery is fully charged, please unplug the charger from commercial power point firstly and then unplug the charger interface from the battery and put the waterproof rubber plug back.
4. During charging, please do not use motor system for the avoidance of accidents.

Notes of signal light: if the charger is connected to the commercial power, green light flickers or is normally on in the case of on battery; in the case of battery connection, red light normally on indicates that the bicycle is being charged while the green light normally on indicates charging completed.

YOU SHOULD READ THIS MANUAL

Thank you for your purchasing on GOSPADE electric bike. Your electric bike is legally a vehicle. It can be ridden on roads mixing with other traffic. For your safety and for the safety of others, we recommend that you obey all road regulations and wear a protective helmet. For optimal, safe and enjoyable use of the e-bike, make sure you thoroughly read this user guide before you first use it. Use the e-bike according to the user guide, or it may shorten the life cycle.

THINGS YOU MUST KNOW BEFORE USE

Please read this manual carefully before operating your e-bike in order to familiarize yourself with the bike and its different functions.

Please learn and observe all the road rules while riding your e-bike on public roads, including ALWAYS wearing an approved helmet.

The helmet should:

- ☒ Be comfortable to the rider
- ☒ Be of lightweight
- ☒ Have good ventilation for the head
- ☒ Fit snugly
- ☒ Cover the forehead



It is your responsibility to familiarize yourself with the laws of the state where you ride and to comply with bicycle laws.

Young children, pregnant women and any persons with vision, balance, or other problems that would prevent them from riding a bicycle should not use the e-bike. The e-bikes are not designed for two riders. Please ensure only one person at a time is riding the e-bike.

Do not operate your electric bike after consuming any amount of alcohol or taking any drugs.

All photos are for general reference only and may differ slightly for each model of e-bike.

Safety Instructions:

1. Recommendations for safe riding - use of a bicycle helmet, regular checks on brakes, tyres, steering, rims and caution concerning possible increased braking distances in wet weather.
2. Inflation of front and rear tires should be moderate as excessive inflation can incur severe bumping and too little inflation has an adverse influence on cycling speed otherwise; in addition, not only can the outer tube be damaged, but tire tube ruptures giving rise to blow-by.
3. After you have ridden the new bicycle for a period, please inspect and adjust it in a comprehensive manner to make sure that all fasteners are effectively locked. In addition, please keep all transmissions flexible. Recommended tightening of fasteners related to the handlebar, handlebar-stem, saddle, seat-pillar, and wheels, with torque values for threaded fasteners. Please use the correct approved light and reflector according to the standard in different country.
4. Please apply lubricating oil onto all transmissions moderately; and it cannot be used continuously under the circumstance of oil shortage.

5. The bicycle should be placed where is dry and ventilated and prevented from contacting any corrosive gas or liquid. Lithium battery of it is strictly prohibited to get close to fire.

6. Although the bicycle can go through rain or snow, water immersion or long-term exposure to the sun is not allowed.

7. Chargers and other accessories that are not particularly designed by the company for this product are forbidden. For any accident caused by it, the company shall not take any responsibility.

8. The bicycle shall not be dismantled or refitted arbitrarily and the company does not bear losses incurred by it. In addition, you may also lose the warranty commitment. In the case that breakdown takes place internally, please contact local dealer or the designated service center.

9. For children, pregnant women and the elderly, the electric power assisted bicycle shall not be used.

WARNING: As with all mechanical components, the bicycle is subjected to wear and high stresses. Different materials and components may react to wear or stress fatigue in different ways. If the design life of a component has been exceeded, it may suddenly fail possibly causing injuries to the rider. Any form of crack, scratches or change of colouring in highly stressed areas indicate that the life of the component has been reached and it should be replaced.

The company reserves all the right for final explanation to all terms and matters mentioned in this Instruction.

Some instructions on battery maintenance and charging

1. Please charge the battery for 4-6 hours after its energy is consumed for 50%-70% of its total energy, in this way, the battery life will be longer. If you leave the battery pack in your stock in less energy condition, it will sleep to die easy. So please charge the battery pack full after each long distance ride. Do not charge the battery for a long time (that is "exceeds 10 hours") in summer; in case that the battery will be calorifacient and broken.
2. Recharging battery once a month during the period of storage.
3. Charging temperature: 0-45℃
4. Battery pack might not been fully charged when temperature is over low or over high. When the battery is charged, its temperature may become a little higher, it is normal under the temperature of 50℃. If the charger indicator is useless when the battery is full charged or the battery is very hot (that exceeds 50℃), please come to the seller to find maintenance at once.
5. Do not make the charger jolty in the rear box if there is one box attached; and the charger should be far away from water. The impact and shake should be at the lowest degree when the battery is moved.
6. Each special designed charger is provided for each battery pack. Do not use other type of charger for fear of burning out battery and causing danger.
7. Battery storage conditions: cleanliness, coolness, dryness and airiness, temperature 0℃~45℃. No solarization, fire, water-logging and mixing the

battery together with corrosive substance during battery shipping and storage.

9. Please sure that there is no short-circuit in your wall socket for fear of burning out battery and causing danger.

BATTERY DISPOSAL

WARNING!

NEVER throw batteries away in the trash. Take the exhausted battery to a federally or state-approved battery recycle center. Call your waste collection service to find out if they offer disposal of batteries.

* Warranty card *

Product information	
model	
Machine Code	
Dealer	
Sales Date	

The starting date of the warranty is the invoice date of the purchasing